



Lexington-Fayette Urban County Government
DEPARTMENT OF ENVIRONMENTAL QUALITY & PUBLIC WORKS

Jim Gray
Mayor

Dowell Hoskins-Squier, P.E.
Commissioner

January 27, 2016

Mentelle Neighborhood :

The following petition is provided for requesting the Division of Traffic Engineering to change Franklin Avenue from a One-Way street back to a Two-Way street. The petition area includes all properties in the neighborhood bounded by Walton Ave. and N Ashland Ave. (see enclosed exhibit as a reference). A total of 12 signatures out of 18 are needed to meet the 65% threshold in order to proceed with the study. **Only one signature can be applied to each property parcel.**

Once a successful petition is produced, then the Division of Traffic Engineering will proceed to schedule the street for data collection. The data will then be processed and checked against criteria. The criteria used by the Division of Traffic Engineering are provided in the *Neighborhood Traffic Management Manual*. A copy of the manual is included.

Please return the petition after it is completed to the following address:

Division of Traffic Engineering
101 E. Vine Street, Suite 300
Lexington, KY 40507-1470

Please look over this information and share it with your neighbors; feel free to call myself should you have questions.

Sincerely,

George M. Thornsby, P.E.
Traffic Engineer
Division of Traffic Engineering
(859) 258-3830 Fax: (859) 425-2054

GMT/dbt

cc: Jake Gibbs, 3rd District Councilmember
Dowell Hoskins-Squier, P.E., Commissioner of Environmental Quality & Public Works
Jeffrey Neal, P.E., Acting Director of Traffic Engineering
Jim Woods, P.E., P.L.S., Deputy Director of Traffic Engineering
Roger T. Mulvaney, P.E., Traffic Engineer Manager
Sally Warfield, Legislative Aide to CM Gibbs

NTMP PETITION FORM

We the undersigned, as residents of Franklin Ave. hereby request the evaluation of the traffic problem(s) being identified as _____.

We petition the LFUCG to begin the development of a Neighborhood Traffic Management project.

We understand that the LFUCG will, upon receipt of a petition that demonstrates the support of 65% of property owners/residents, analyze relevant conditions to determine the impact of the proposed action. The LFUCG must reserve the right to overrule the petition if there are extenuating circumstances detrimental to public safety, traffic operations, and/or neighborhood interests.

Please list all addresses in the petition area. One signature per property parcel permitted.

DATE	NAME (PLEASE PRINT)	ADDRESS	SIGNATURE
		700 FRANKLIN AVE.	
		701 FRANKLIN AVE.	
		702 FRANKLIN AVE.	
		703 FRANKLIN AVE.	
		704 FRANKLIN AVE.	
		705 FRANKLIN AVE.	
		706 FRANKLIN AVE.	
		707 FRANKLIN AVE.	
		708 FRANKLIN AVE.	
		709 FRANKLIN AVE.	
		711 FRANKLIN AVE.	
		713 FRANKLIN AVE.	
		715 FRANKLIN AVE.	
		722 FRANKLIN AVE.	
		726 FRANKLIN AVE.	
		700 FRANKLIN AVE.	
		155 N ASHLAND AVE	
		163 N ASHLAND AVE	

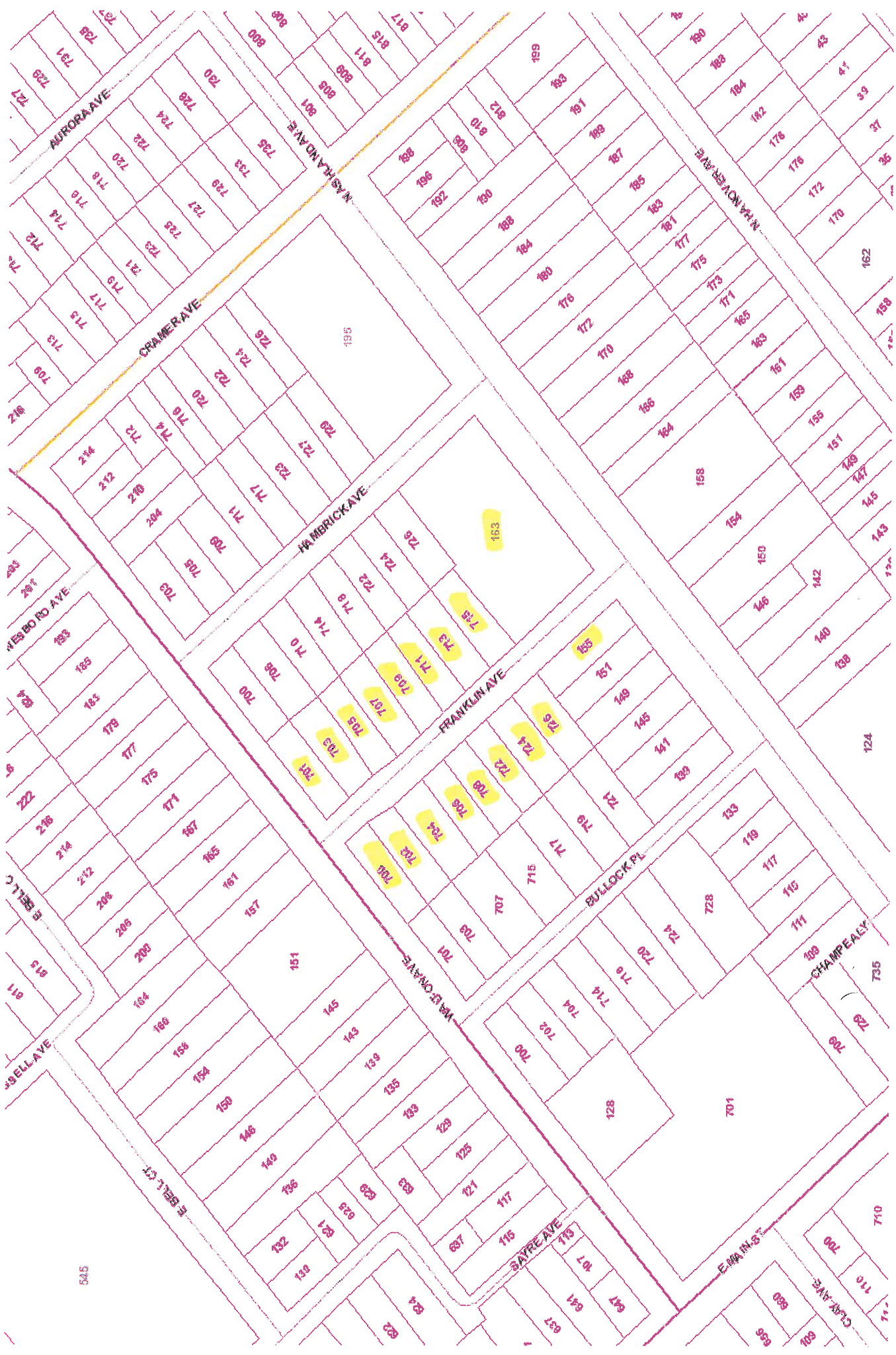

545

AURORA AVE

CRAMER AVE

HAMBRICK AVE

FRANKLIN AVE

BULLOCK PL

W.B. CRAYNE

SAYRE AVE

EMMA INST

CLARK AVE

N.W. BAKER AVE

CHAMPELLEY

124

710

700

700

700

700

700

700

700

700

700

700

700

700

700

700

700

700

700

